

# AUDI 4G PAS

## Parking Assist System



### REAR INTERFACE

MODEL.	AD 4G PAS-150211
DATE.	2020.04.23

## 1. Input Spec. (MULTI VIDEO INTERFACE)

- 1 x Analog RGB Input (Navigation System output)
- 1 x CVBS(REAR CAMERA) Input (Rear camera source)
- 1 x CVBS(FRONT CAMERA) Input (Front camera source)
- 1 x LVDS Input (Car Command System)

## 2. Output Spec.

- 1 x LCD Output (LCD Operation)

## 3. Power Spec.

- Input Power : 8VDC ~ 24VDC
- Consumption Power : 12Watt, Max

## 4. Switch Input Mode.

- Possible to select CAR model while switching mode by DIP S/W
- By button on the Commander in the car via CAN

# External Appearance



# Connector Pin Assignment



▲ Power/CAN    ▲ NAVI

## POWER Connect

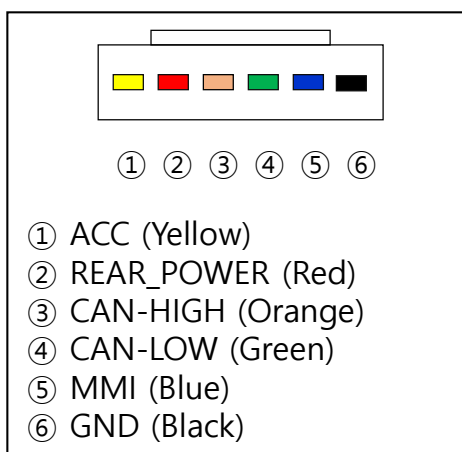

## NAVI Connect

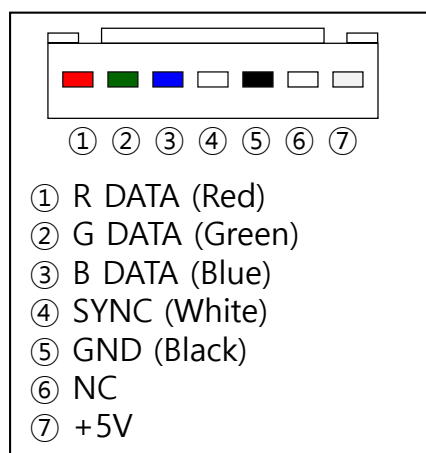

# Product Composition

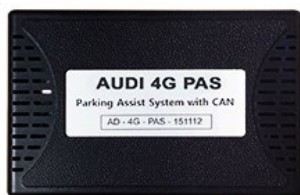

**Interface**



**Power Cable**



**RGB NAVI Cable (5PIN)**



**LVDS Cable (O Type)**



**Rear Detect Cable**



**OSD Board**

# Dip Switch Setting

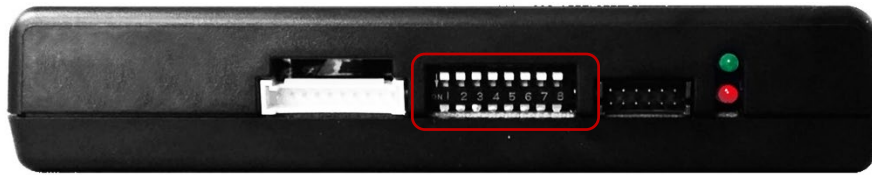

OFF : ▲UP  
ON : ▼DOWN

PIN	FUNCTION	DIP S/W Selection
1	NAVI	ON : Not Used OFF : Used
2	VIDEO Mode	ON : Not used OFF : used
3	N.C	
4	N.C	
5	CAR type SEL	Bottom Picture
6		
7		
8		

## Car Type Select



Audi  
**A3\_5.8"**



Audi  
**A3\_7.0"**



Audi  
**A4/Q7\_7.0"**



Audi  
**A6\_8.0"**



Audi  
**TT\_12.0"**



Bentley  
**Mulsanne\_8.0"**



Volkswagen  
**Golf\_5.8"**



Volkswagen  
**Golf\_6.5"**



Volkswagen  
**Golf\_8.0"**



Volkswagen  
**Polo\_6.5"**



Volkswagen  
**Tiguan\_8.0"**



Porsche  
**PCM4.0\_7.0"**



# Mode Change

for Audi A3 / A4 / Q7 (2016 Year)



• DIP-SW 1 must be OFF in order to install Navigation



MENU	Option / Hand wheel Btn	NAVI
Config	FrontCam-Det	ExtWire
Option	RearCam-RcvOpt	<input type="checkbox"/> Os
Image	SteeringWheelBtn	MODE NAV OFF
Screen	Reset	Execute Cancel
Parking		

- Use by selecting "MODE" or "NAV" from the OSD menu
- (Select "OFF" when the button is not used.)

# Mode Change

for Audi A6 / A7



• DIP-SW 1 must be OFF in order to install Navigation



MENU	Option / Hand wheel Btn	NAVI
Config	FrontCam-Det	ExtWire
Option	RearCam-RcvOpt	<input type="checkbox"/> Os
Image	SteeringWheelBtn	MODE NAV OFF
Screen	Reset	Execute Cancel
Parking		

- Use by selecting "MODE" or "NAV" from the OSD menu
- (Select "OFF" when the button is not used.)



# Mode Change

for Volkswagen Golf7 / Polo



• DIP-SW 1 must be OFF in order to install Navigation



MENU	Option / Hand wheel Btn	NAVI
Config	FrontCam-Det	ExtWire
Option	RearCam-RcvOpt	<input type="checkbox"/> Os
Image	SteeringWheelBtn	MUTE DOWN OFF
Screen	Reset	Execute Cancel
Parking		

- Use by selecting "MUTE" or "DOWN" from the OSD menu
- (Select "OFF" when the button is not used.)

# Mode Change

for Audi TT



• DIP-SW 1 must be OFF in order to install Navigation



MENU	Option / SteeringWheelBtn	NAVI
Config	FrontCam-Det	ExtWire
Option	FrontCam-RcvOpt	<input type="checkbox"/> 0s
Image	AV Out	USER
Screen	SteeringWheelBtn	STAR OFF
Parking	SteeringChannel	Off

- Use by selecting "STAR" from the OSD menu
- (Select "OFF" when the button is not used.)

# OSD Control

## OSD(On Screen Display) Control Board

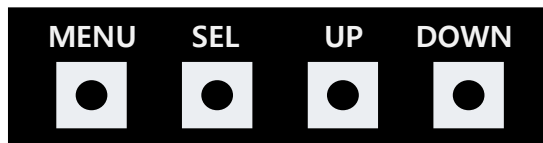

<b>MENU</b>	<ul style="list-style-type: none"> <li>The OSD screen can be switched ON/OFF</li> <li>Return to previous menu</li> </ul>
<b>SEL</b>	<ul style="list-style-type: none"> <li>Select the currently active item</li> <li>If the OSD screen is off, mode changes can be made.</li> </ul>
<b>UP</b>	<ul style="list-style-type: none"> <li>Move up from the menu</li> <li>Increase the selected item value</li> </ul>
<b>DOWN</b>	<ul style="list-style-type: none"> <li>Move down from the menu</li> <li>Decrease the selected item value</li> </ul>

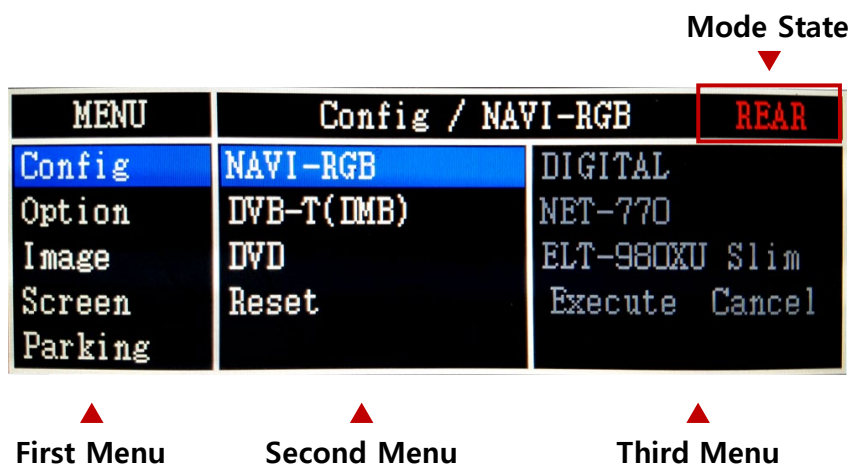

# OSD Control

## Config

MENU	Config <span style="float: right;">NAVI</span>	
Config	NAVI-RGB	DIGITAL-INAVI
Option	DVB-T(DMB)	ELT_DVBT20
Image	DVD	ELT-980XU Slim
Screen	Reset	Execute Cancel
Parking		

First Menu	Second Menu	Third Menu	Description
Config	NAVI-RGB	INAVI_ WVGA :	Setting the Connected NAVI Model
	Reset	Execute	Reset to default value of Config menu

# OSD Control

## Option

First Menu	Second Menu	Third Menu	Description
Option	RearCam-Type	OEM	Original Camera
		ExtDevice	External rear Camera
	RearCam-Power	ON	Continuously supply + 12V
		AUTO	Supply + 12V only in Rear mode.
		OFF	Power off the rear camera.
	RearCam-Det	PDC	Detected by P >> button (CAN)
		GEAR	Detected by GEAR (CAN)
		WIRE	Detected by Rear-Detect Wire
	RearCam-RcvOpt	ON	Show Front Cam after Rear Cam. Set the time to show. (Max 30 second)
		OFF	Do not use features.
	Steering Mode	MODE	" <b>MODE</b> " Switching screen by using Steering wheel button
		NAV	" <b>NAV</b> " Switching screen by using Steering wheel button
		OFF	Do not use features.
	Reset	Execute	Reset value of option menu

# OSD Control

## Rear Detect Control

MENU	Option / RearCam-Det	REAR
Config	RearCam-Type	ExtDevice
Option	RearCam-Power	Auto
Image	RearCam-Det	PDC GEAR ExtWire
Screen		ExtDevice
Parking		Auto



Car Audio Box Button

MENU	Option / RearCam-Det	REAR
Config	RearCam-Type	ExtDevice
Option	RearCam-Power	Auto
Image	RearCam-Det	PDC GEAR ExtWire
Screen		ExtDevice
Parking		Auto

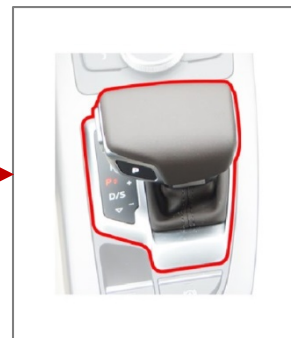

Gear

• If it does not work with CAN, work with a separate WIRE.



MENU	Option / RearCam-Det	REAR
Config	RearCam-Type	ExtDevice
Option	RearCam-Power	Auto
Image	RearCam-Det	PDC GEAR ExtWire
Screen		ExtDevice
Parking		Auto



# OSD Control

## Image

### NAVI – RGB Menu

First Menu	Second Menu	Third Menu	Description
Image	Brightness		Adjust the value of brightness
	Contrast		Adjust the value of contrast
	Color-RED		Adjust the value of RED
	Color-GREEN		Adjust the value of GREEN
	Color-BLUE		Adjust the value of BLUE
	Reset	Execute	Option Menu all Reset

### DVD / DVBT / NAVI-AV,REAR,FRONT Menu

First Menu	Second Menu	Third Menu	Description
Image	Brightness		Adjust the value of brightness
	Contrast		Adjust the value of contrast
	Saturation		Adjust the value of Saturation
	Hue		Adjust the value of Hue
	Sharpness		Adjust the value of Sharpness
	Reset	Execute	Option Menu all Reset

**Brightness**



**Contrast**



**Saturation**



# OSD Control

## Screen

MENU	Horizontal	NAVI
Config	Horizontal	50
Option	Vertical	50
Image	Scale X Up	50
Screen	Scale X Down	50
Parking	Scale Y Up	50

First Menu	Second Menu	Third Menu	Description
<b>Screen</b>	Horizontal		Output screen horizontal movement
	Vertical		Output screen vertical movement
	Scale X Up		Reduce / increase output screen width
	Scale X Down		
	Scale Y Up		Reduce / Increase Output Screen Height
	Scale Y Down		
	Reset		Screen menu all reset

# OSD Control

## Parking

MENU	OPS Display	REAR
Config	OPS Display	Off
Option	Line Display	Off
Image	Warnings Lang	English
Screen	Horizontal	<input type="range"/> 50
Parking	Vertical	<input type="range"/> 60

First Menu	Second Menu	Third Menu	Description
Parking	OPS Display	ON	Show OPS
		OFF	OPS is not displayed
	Line Display	ON	Show parking line
		OFF	Parking line is not displayed
	Warnings Lang		Set warning text language
	Horizontal		Moving a parking line horizontally
	Vertical		Moving a parking line vertically
	Transparency		Parking line transparency
	Reset		Parking menu all reset

# OSD Control

## Parking – Parking Line / PDC ON/OFF

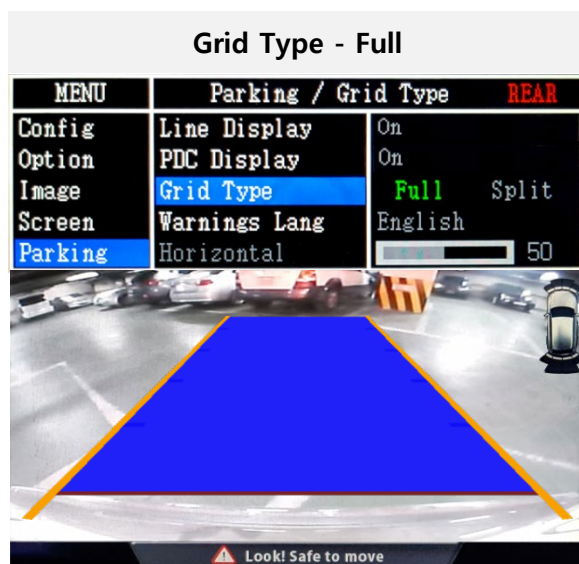
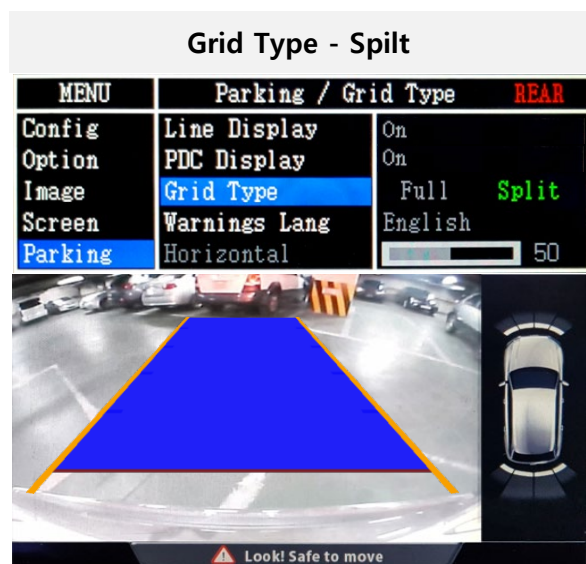
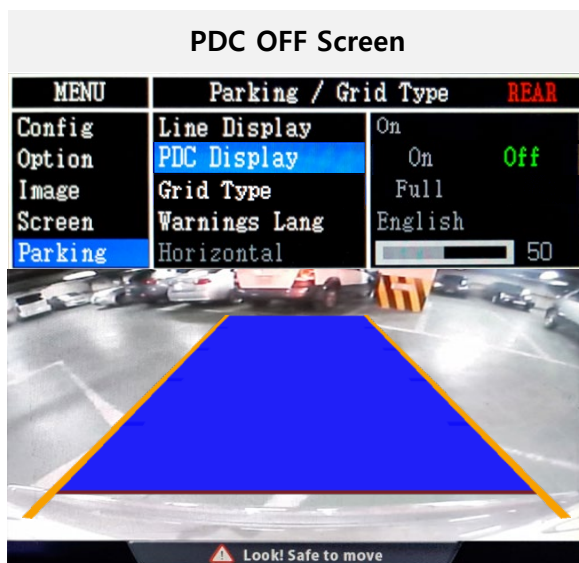
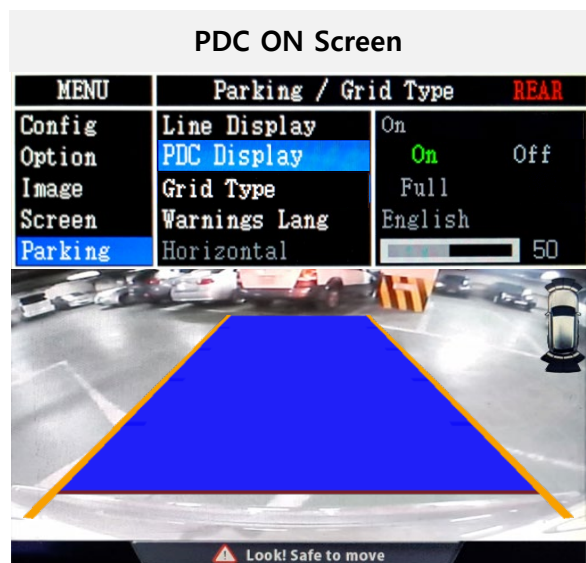

# OSD Control

## Parking – Change warning message language

MENU	Parking / Warnings Lang	REAR
Config	OPS Display	English
Option	Line Display	中文
Image	Warnings Lang	한국어
Screen	Horizontal	台灣
Parking	Vertical	Россия

English

Check entire surroundings!

中文

请注意车辆周围环境!

한국어

차량 주변을 전부 확인

台灣

請注意車輛周圍環境!

Россия

Следите за всем окружением автомобиля!

日本

周辺の安全を確認

# OSD Control

## Parking – Adjust position of parking guide line

MENU	Parking	REAR
Config	OPS Display	Off
Option	Line Display	On
Image	Warnings Lang	English
Screen	Horizontal	<input type="range"/> 50
Parking	Vertical	<input type="range"/> 50



- Pressing this Horizontal / Vertical menu, The OSD screen automatically disappears.
- Possible to adjust the position of parking guide line by Keypad in Horizontal / Vertical menu
- Please adjust from the parking line Screen.

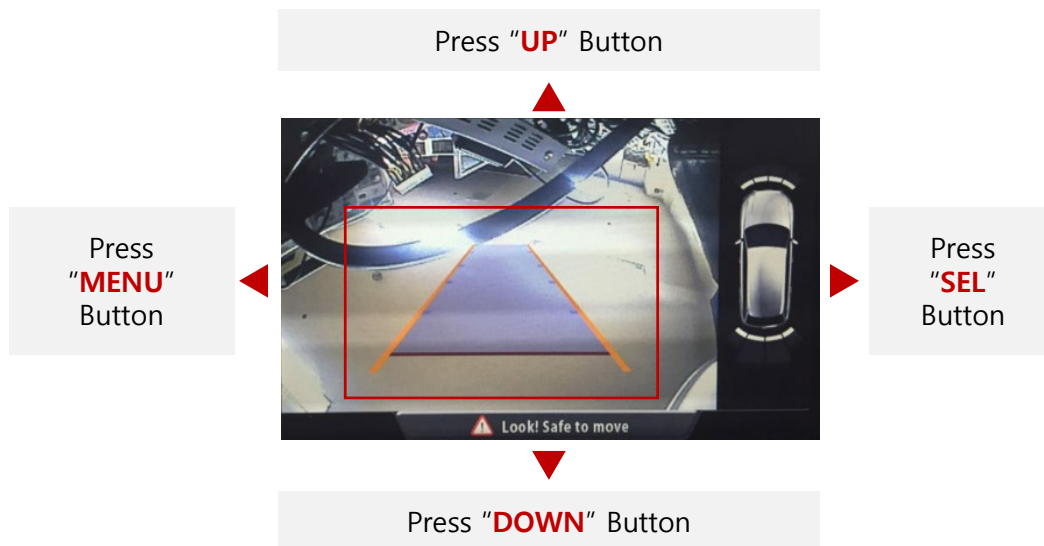



# OSD Control

## OSD

MENU	Horizontal	DVB-T
OSD	Horizontal	50
IR-Ctrl	Vertical	50
Utility	Display Time	10s
	Transparency	30
	Language	English

MENU	Reset	DVB-T
OSD	Reset	Execute Cancel
IR-Ctrl		
Utility		

First Menu	Second Menu	Third Menu	Description
OSD	Horizontal	<i>value</i>	OSD Menu Horizontal Shift
	Vertical	<i>value</i>	OSD menu vertical Shift
	Display Time	<i>value</i>	OSD Menu Display Time (in seconds)
	Transparency	<i>value</i>	OSD menu transparency
	Language		OSD menu display language
	Reset	Execute	Initialize OSD settings

# OSD Control

## Utility

MENU	Utility	NAVI
OSD	Factory Reset	Execute Cancel
IR-Ctrl	Version	FDSYOOKRX-180209
Utility		

First Menu	Second Menu	Third Menu	Description
Utility	Factory Reset	Execute	Initialize all settings
	Version		FDSYOOKRX-180209 (Check for future upgrades)

- Last Source : **FDSYOOKRX-180209**

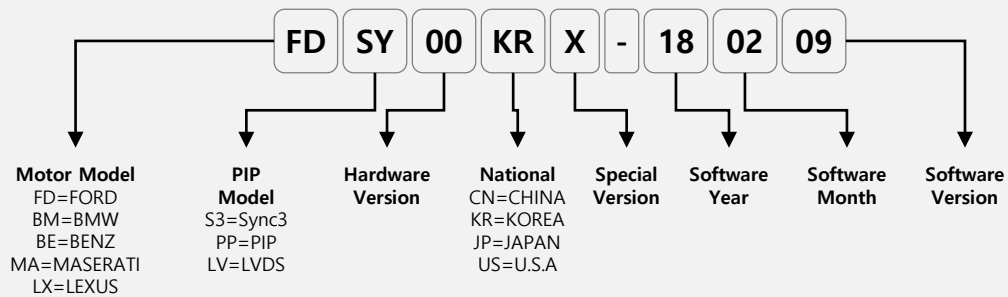

# Install Manual

## 1. Installation Diagram

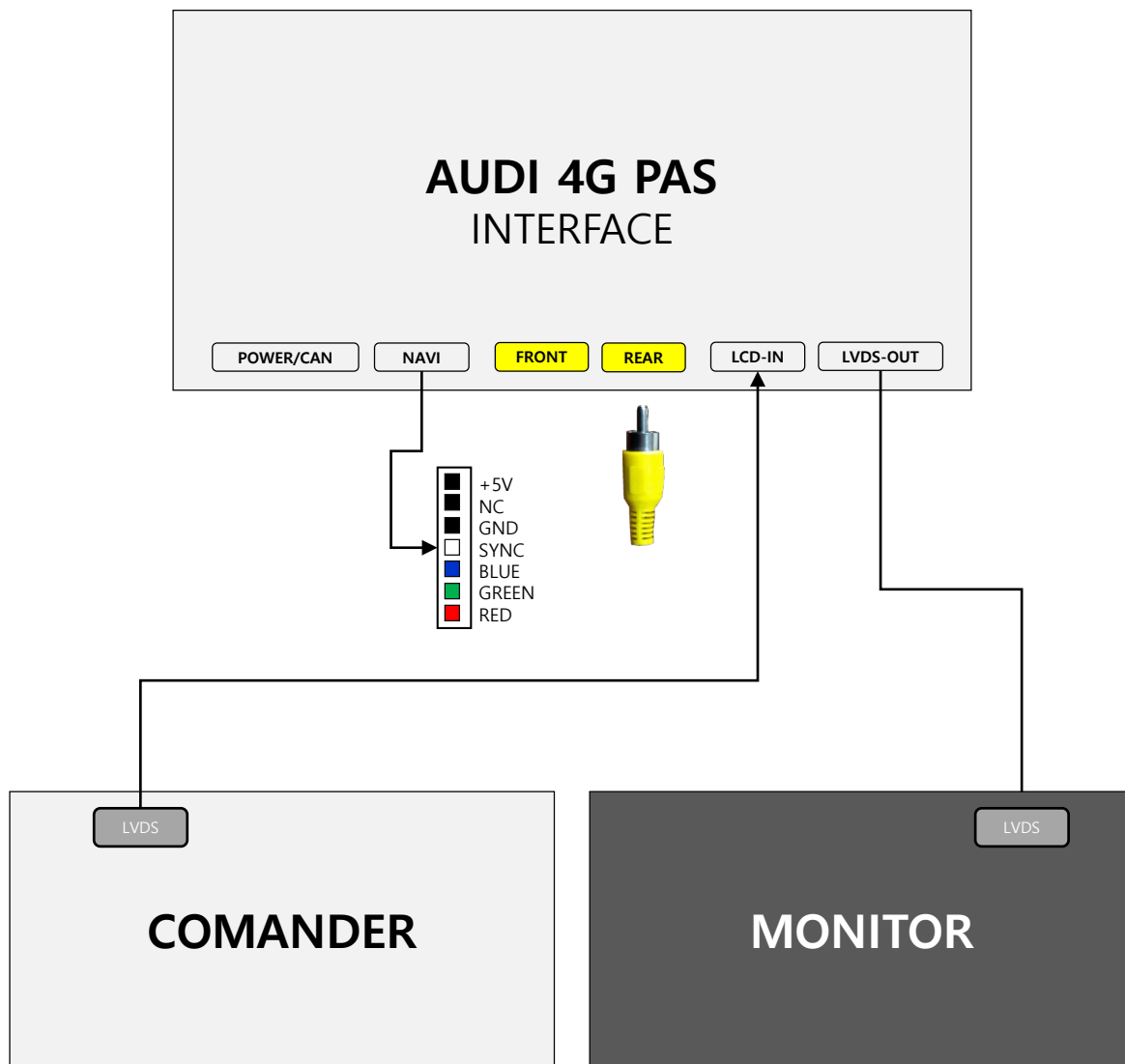

# Install Manual

## 2. Installation External Reverse(Rear) Camera Connection

### OSD Screen selection CAN

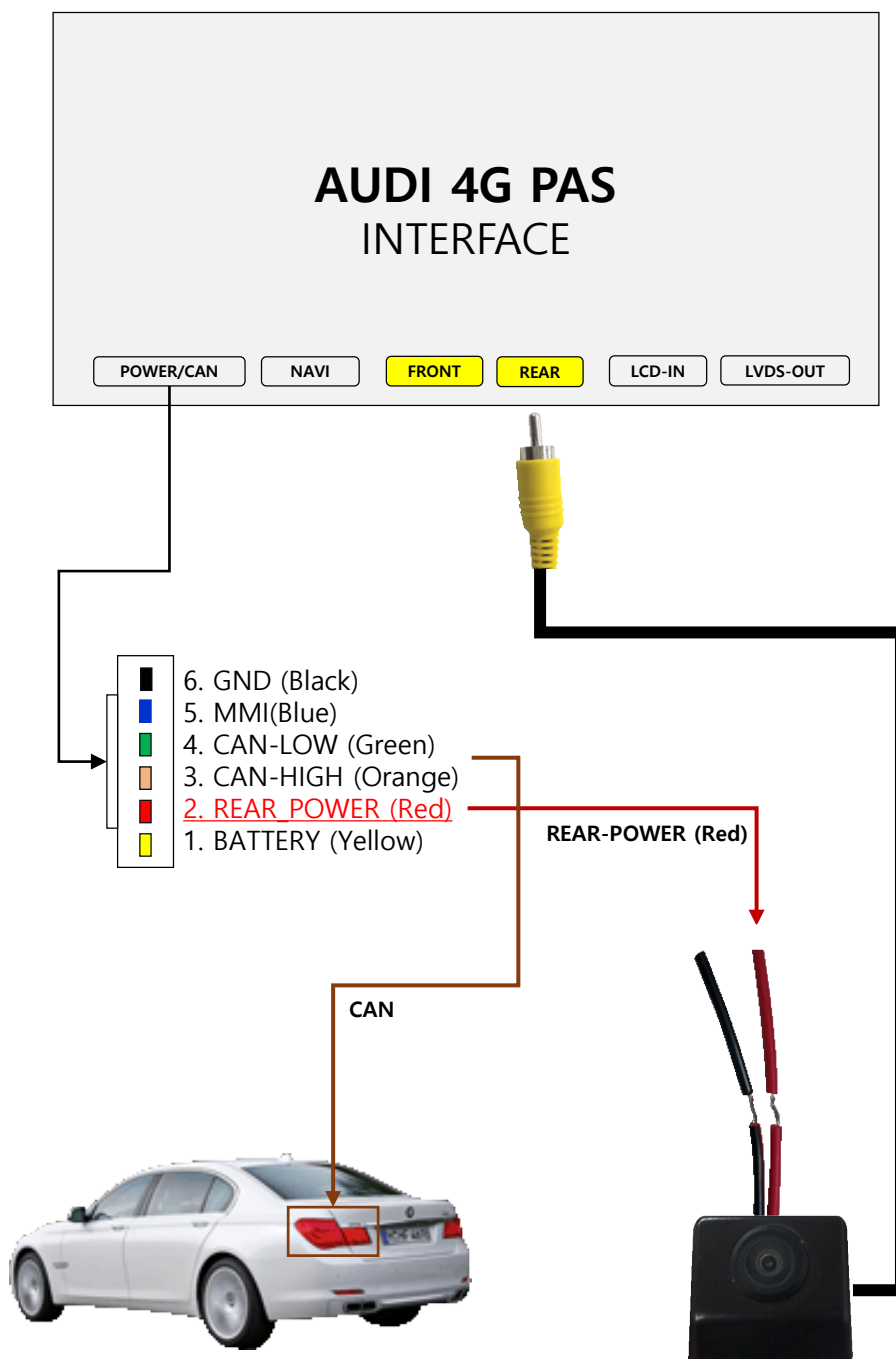

# Install Manual

## 3. Installation LVDS connection

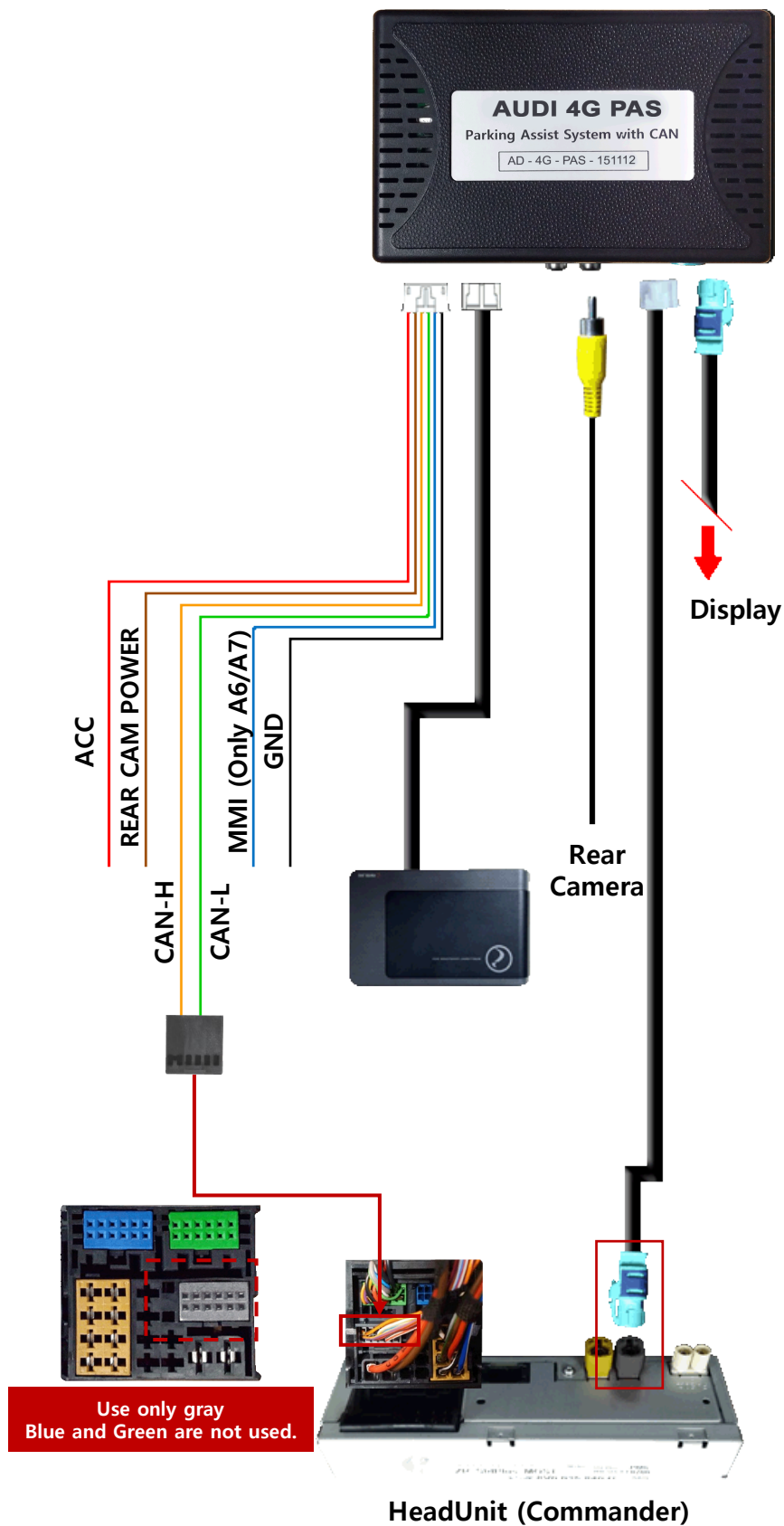

# Install Manual

## 4. Installation CAN connection

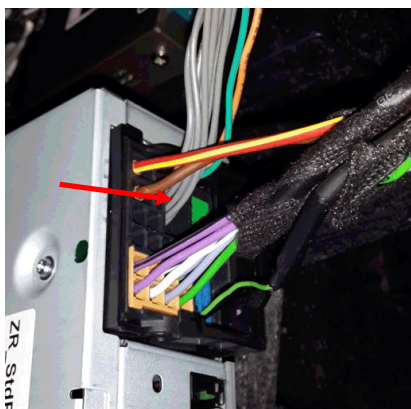

Remove the original gray connector.

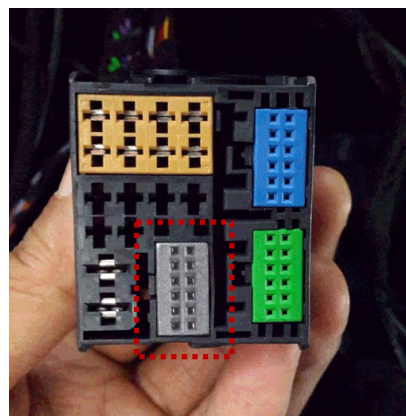

Check the gray area

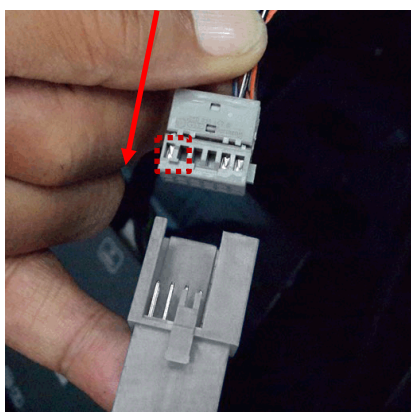

Be careful of the protruding part, connect the connector

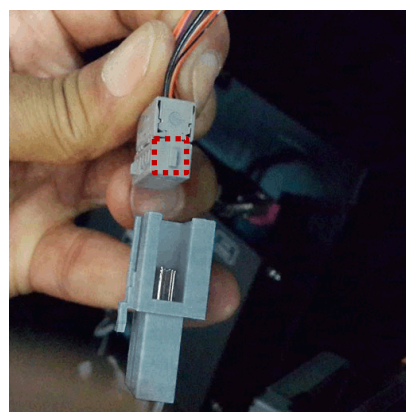

Be careful of the protruding part, connect the connector





**A-912 RM Tera-Tower2, 201  
Songpa-Daero, Songpa-gu, Seoul, Korea**

**F. (+82) 6204-0913**

**E. [kap@kaptrader.com](mailto:kap@kaptrader.com)**